

**DLM-650-NL**      **RED LASERS: 650 nm, 100~1000 mW**

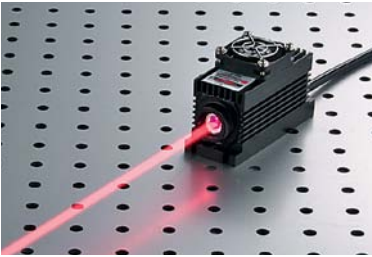

- Collimated Diode Lasers
- Easy use & maintenance free
- Longlife operation
- High efficiency
- High reliability

- APPLICATIONS**
- Laser show
  - Display
  - Laser Alignment
  - Scanning Biochemistry
  - Material Inspection LIDAR

**SPECIFICATIONS**

Wavelength	650 nm
Spatial Mode	Multimode
Output Power	100, 200, ..., 1000 mW
Operation Mode	CW or Modulation
Modulation	Analog or TTL 0~30 kHz
Polarization	TM
Pointing Stability	<0.05 mrad
Beam Diameter (1/e <sup>2</sup> )	<4 mm
Beam Divergence	<3 mrad
Power Stability	<±3% per 2 hrs
Temperature Stabilizing	TEC
Warm Up Time	<2 minutes
Expected Lifetime	5,000 hrs
Modulation	0~10 kHz
Laser Head Dimensions	40(W) × 100(L) × 50(H) mm (optional fan adds 15 mm height)
<b>POWER SUPPLY</b>	
OEM type <b>EO-PS-I</b>	58(W) × 100(L) × 32(H) mm AC/DC PSU: 85~265 V 50/60 Hz input
Lab type <b>EO-PS-IIS</b>	104(W) × 128(L) × 89(H) mm 85~265V 50/60 Hz input
Lab Adjustable type <b>EO-PS-II</b>	179(W) × 148(L) × 56(H) mm 85~265 V 50/60 Hz input

**ORDERING INFORMATION**

Catalogue number	Description
DLM-650-NL250	250 mW
DLM-650-NL400	400 mW
DLM-650-NL450	450 mW
DLM-650-NL500	500 mW
DLM-650-NL800	800 mW
DLM-650-NL900	900 mW
DLM-650-NL1000	1000 mW
EO-PS-I	OEM Type power supply
EO-PS-IIS	Lab type power supply
EO-PS-II	Lab adjustable type power supply

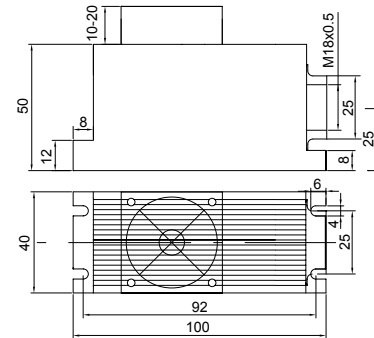

DLM-650-NL

**POWER SUPPLIES**

- OEM power supply **EO-PS-I**
- Lab type power supply **EO-PS-IIS**
- Lab adjustable type power supply **EO-PS-II**

**RELATED PRODUCTS**

Laser Safety Eyewear

See page 1.16.

